

availand

Nordic EVO 2

Quick Guide

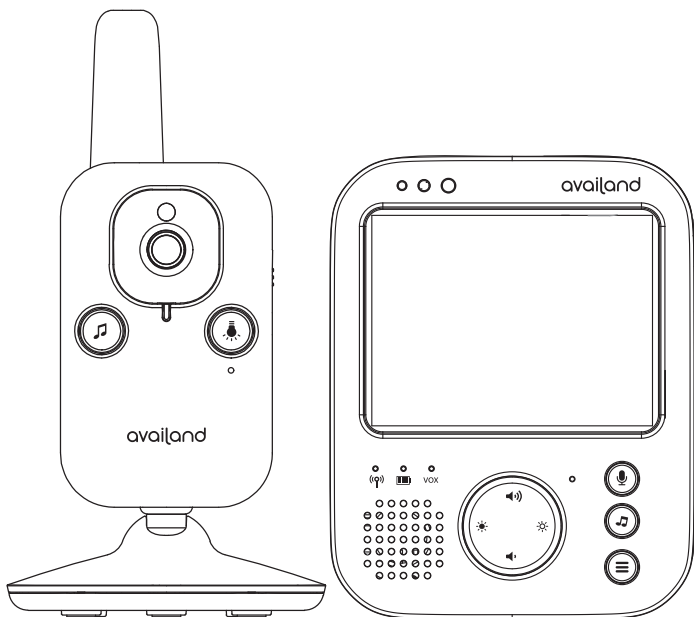



WARNING!

Strangulation Hazard – Children have STRANGLED in cords. Keep this cord out of the reach of children (more than 3.5 ft (1 m) away). Do not remove cord tag.

Package Contents

Baby Unit *1

Parent Unit *1

Power Adapter *2

Wall-mount kit *1

Quick Guide*1



Power

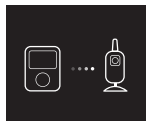
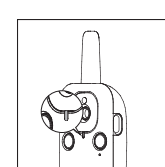
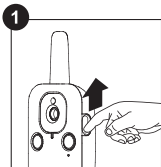
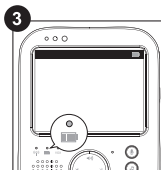
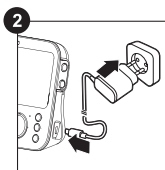
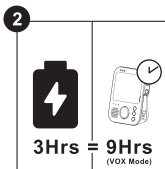
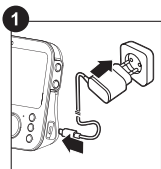

Connection

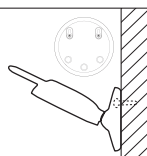
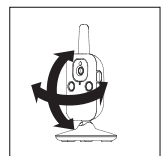
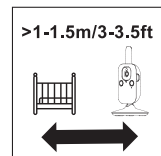
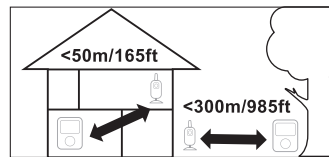
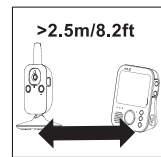
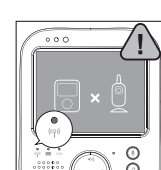
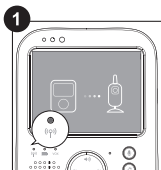

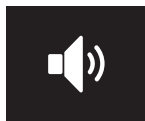

Volume

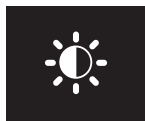
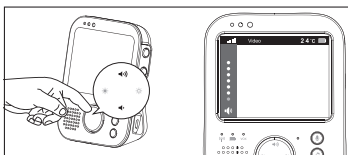

Brightness

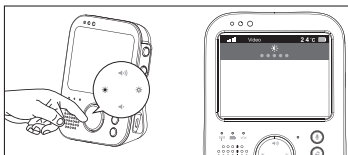

Operation modes

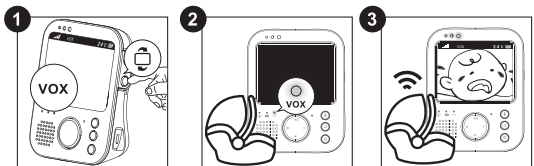
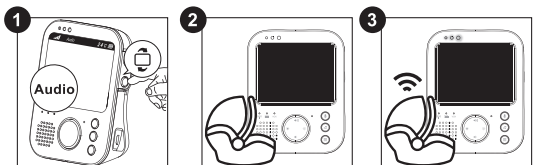
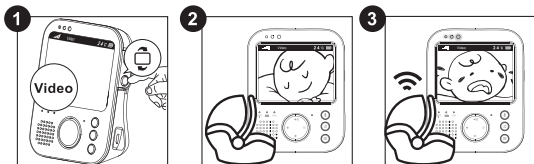

Night light

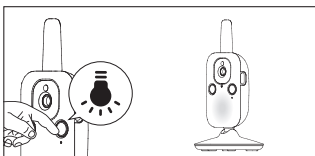



Soothing Lullaby

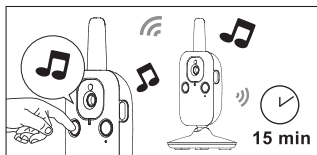
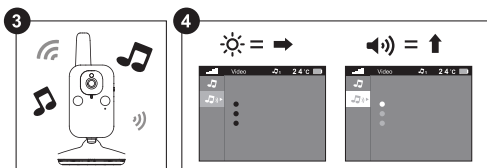
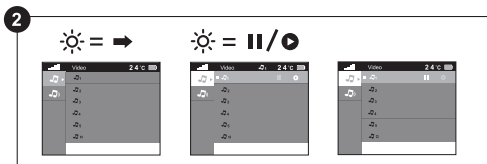
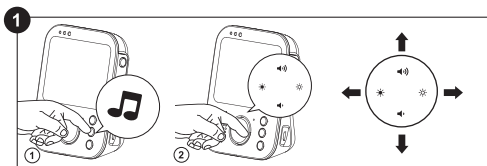

Two-way-talk

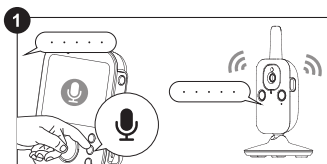

Menu

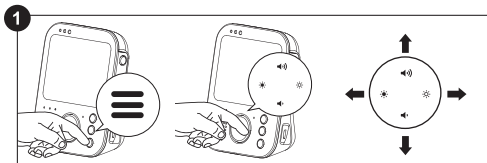



Zoom

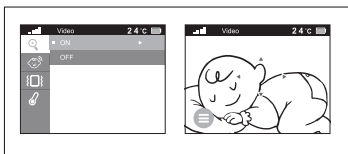

© Digital Pan and Tilt



Voice Activation (VOX)

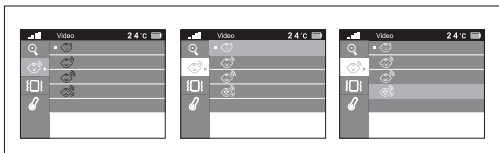

© Sensitivity Low/Medium/High/Very High (Auto mute disabled)

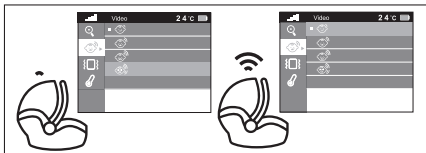

Vibration

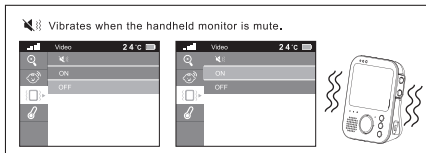

© Vibration ON: it vibrates when sound detected (triggers according to the sensitivity level)



Temperature setting

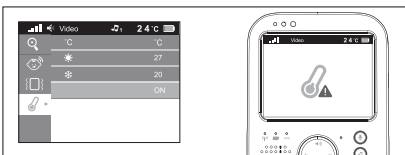
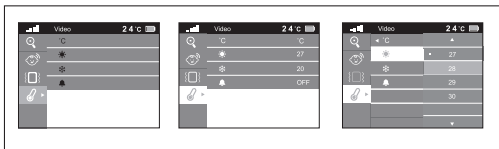

Care and Maintenance

- Keep all parts and accessories out of children's reach.
- Fingerprints or dirt on the lens surface can adversely affect camera performances. Avoid touching the lens surface with your fingers.
- Should the lens become dirty, use a blower to blow off dirt and dust, or a soft, dry cloth to wipe off the lens.
- Keep the camera dry. Precipitation, humidity, and other liquids contain minerals will corrode electronic circuits.
- Do not use or store in dusty, dirty areas.
- Do not store in hot areas. High temperatures can shorten the life of electronic devices and warp or melt certain plastics.
- Do not store in very cold areas. When the system warms up (to its normal temperature), moisture can form inside the case, which may damage electronic circuit boards.
- Do not attempt to open the case. Non-expert handling of the device may damage the system.
- Avoid dropping or strong shocks.
- Operate this product using only with the power supply included or provided as an accessory.
- Do not overload electrical outlets or extension cords this can result in fire or electric shocks.
- Do remember that you are using public airwaves when you use the system and that sound and video may be broadcast to other 2.4 GHz receiving devices. Conversations, even from rooms near the camera, may be broadcast. To protect the privacy of your home, always turn the camera off when not in use.

FCC Statement

This equipment has been tested and found to comply with the limits for a Class B digital device, pursuant to Part 15 of the FCC Rules. These limits are designed to provide reasonable protection against harmful interference in a residential installation. This equipment generates, uses and can radiate radio frequency energy and, if not installed and used in accordance with the instructions, may cause harmful interference to radio communications. However, there is no guarantee that interference will not occur in a particular installation. If this equipment does cause harmful interference to radio or television reception, which can be determined by turning the equipment off and on, the user is encouraged to try to correct the interference by one or more of the following measures:

- Reorient or relocate the receiving antenna
- Increase the separation between the equipment and receiver
- Connect the equipment into an outlet on a circuit different from that to which the receiver is connected
- Consult the dealer or an experienced radio/TV technician for help

This device complies with Part 15 of the FCC Rules. Operation is subject to the following two conditions: (1) this device may not cause harmful interference, and (2) this device must accept any interference received, including interference that may cause undesired operation.

Specifications

Camera Frequency Image Sensor Lens IR LED Dimensions Weight Power Adapter Operating temperature	2.4 GHz CMOS image sensor f3.0mm, F 2.8 1pcs 85 (W) x 165(H) x 85(D) mm 122.5g ±5g Input: 100-240V~0.2A, 50/60Hz 12-16VA Output: 5.0V DC, 1.0A 0°C ~ 40°C (32°F ~ 104°F)	Monitor Frequency Display Display colors Brightness Control VOX Dimensions Weight Power Adapter Battery Capability Operating temperature	2.4 Ghz 3.5" TFT LCD Full-color 5 levels Voice activation, Audio mode 90 (W)x 115(H) x 41(D) mm 188g±5g Input: 100-240V~0.2A, 50/60Hz 12-16VA Output: 5.0V DC, 1.0A 3.7V, 2600mAh (Li-ion) 0°C ~ 40°C (32°F ~ 104°F)
--	--	---	--

Specifications subject to change without notice



This device is for indoor use only



Avviso!

Pericolo di strangolamento: i bambini potrebbero STRANGOLARSI con i cavi. Tenere il cavo fuori dalla portata dei bambini (oltre 1 m (3,5 ft) di distanza). Non rimuovere l'etichetta del cavo.

Contenuto della confezione

Unità bambino *1

Unità genitore *1

Adattatore di alimentazione *2

Kit di montaggio a parete *1

Guida rapida *1



Alimentazione

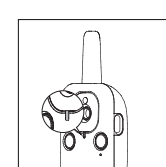
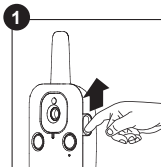
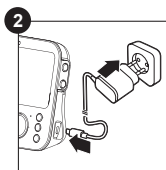
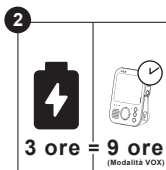
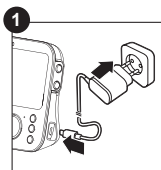

Connessione

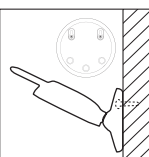
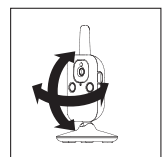
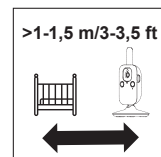
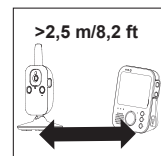
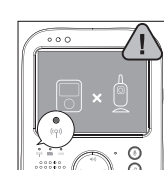
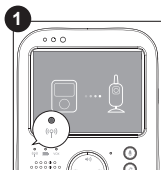

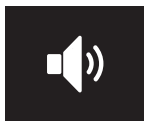

Volume

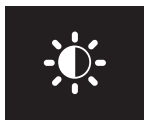
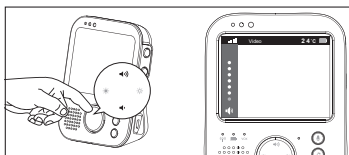

Luminosità

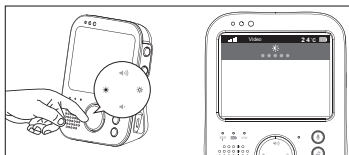

Modalità operative

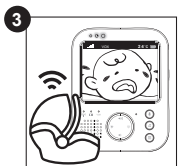
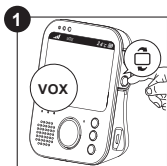
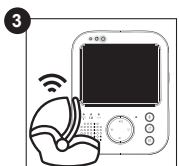
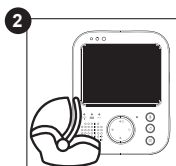
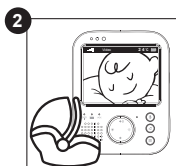

Luce notturna

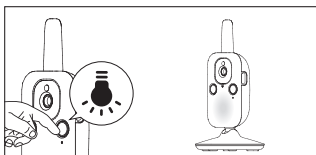



Ninna nanna
rilassante

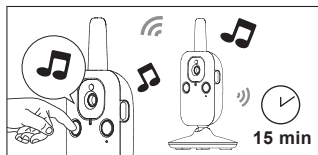
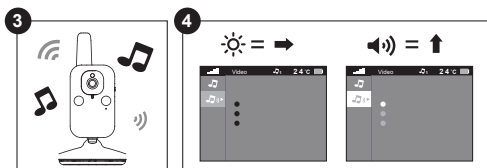
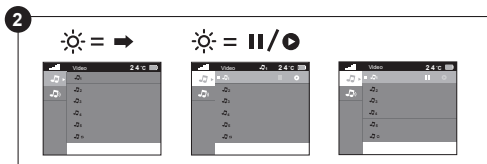
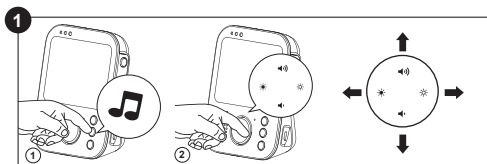

Conversazione
bidirezionale

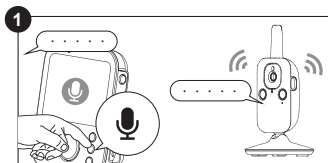

Menu

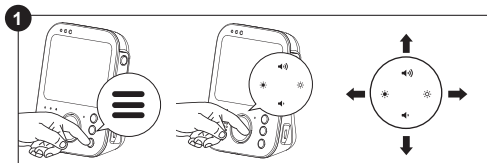



Zoom

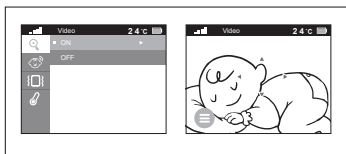

⊙ Pan/Tilt digitale



**Attivazione
voce (VOX)**

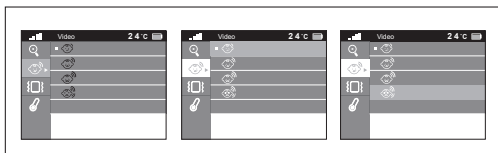

⊙ Sensibilità Bassa/Media/Alta/Molto alta (Silenzamento automatico disabilitato)



Vibrazione

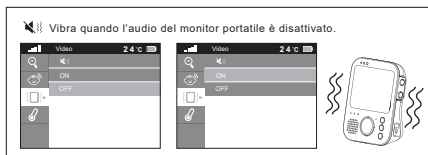

⊙ Vibrazione ON: vibra quando viene rilevato un suono (si attiva in base al livello di sensibilità)



**Temperature
Setting
(Impostazione
temperatura)**

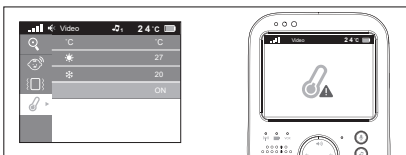
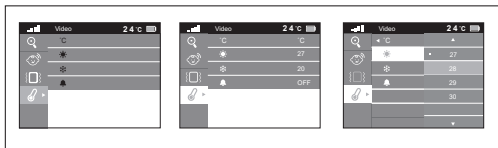



Advertencia!

Peligro de estrangulamiento: los niños se han **ESTRANGULADO** con cables. Mantenga este cable fuera del alcance de los niños (a más de 1 m (3,5 ft) de distancia). No quite las etiquetas del cable.

Contenido del paquete

Unidad del bebé *1

Unidad de los padres *1

Adaptador de alimentación *2

Juego de montaje en pared *1

Guía rápida *1



Alimentación

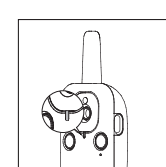
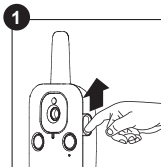
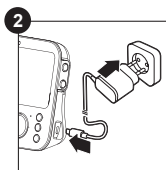
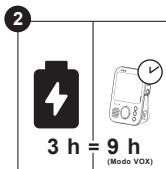
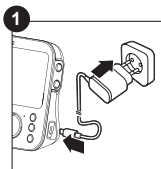

Conexión

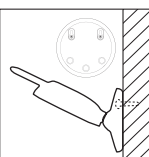
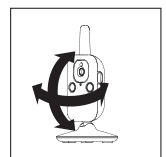
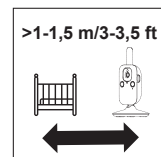
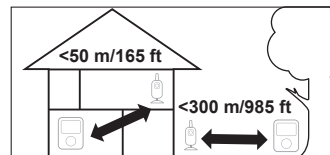
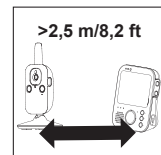
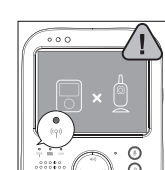
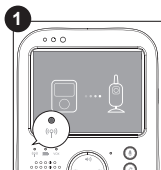

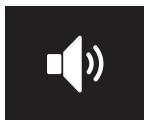

Volumen

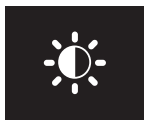
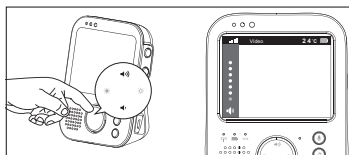

Brillo

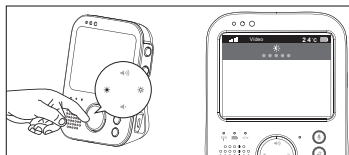

Modos de funcionamiento

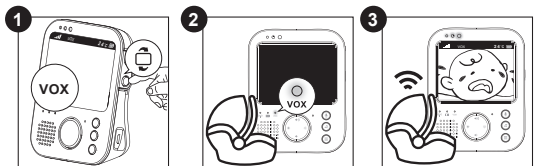
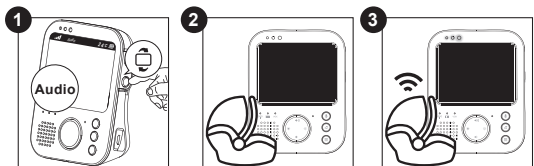
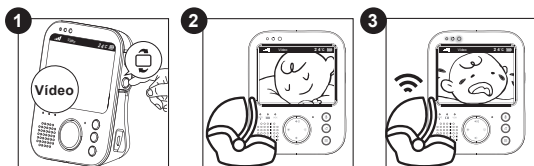

Luz nocturna

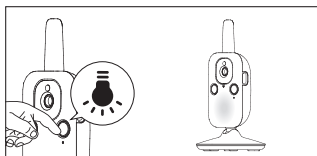



**Canción de
cuna relajante**

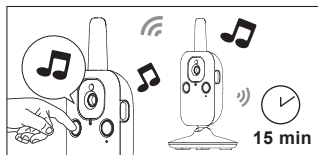
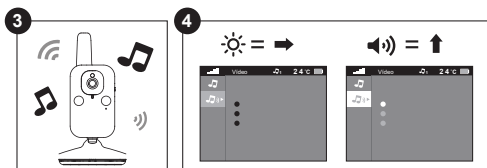
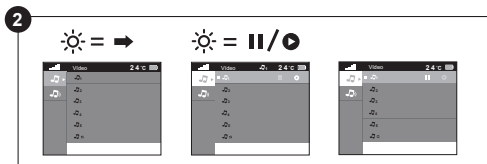
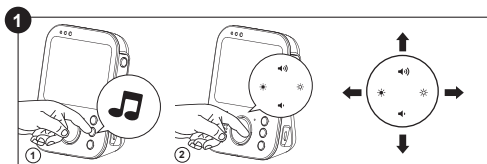

**Conversación
bidireccional**

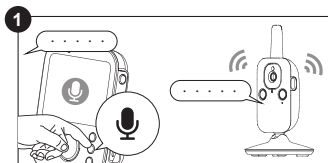

Menú

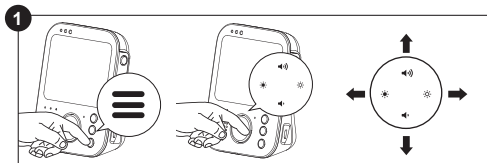

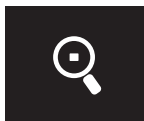

Zoom



⊙ Panorámica e inclinación digitales



Activación por voz (VOX)

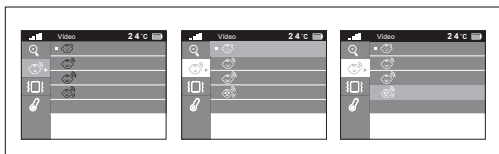

⊙ Sensibilidad baja, media, alta o muy alta (silencio automático deshabilitado)

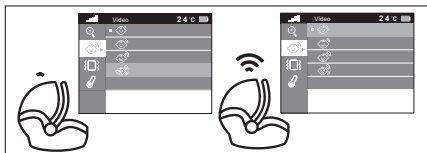

Vibración



⊙ Vibración ACTIVADA: vibra cuando se detecta sonido (se dispara según el nivel de sensibilidad)



Configuración de la temperatura

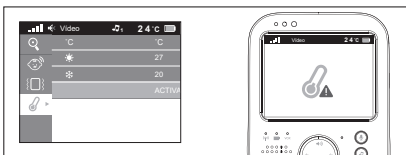
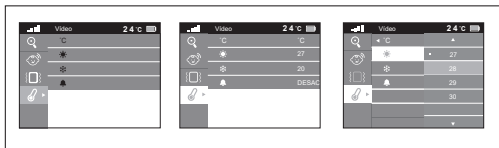



Avertissement !

Risque d'étranglement - Les enfants peuvent s'étrangler avec les cordons. Gardez ce cordon hors de la portée des enfants (minimum 3,5 pieds/1m). N'enlevez pas l'étiquette du cordon.

Contenu de la boîte

Unité pour bébé *1

Unité pour parents *1

Adaptateur d'alimentation *2

Kit de montage mural *1

Guide rapide *1



Alimentation

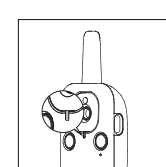
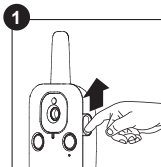
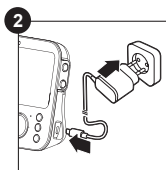
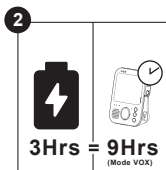
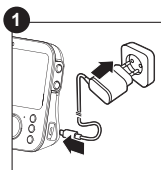

Connexion

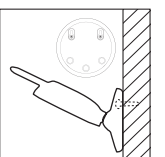
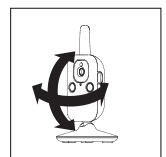
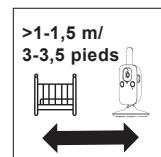
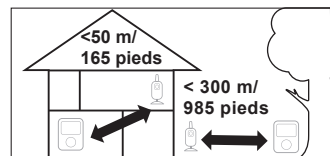
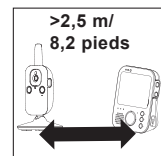
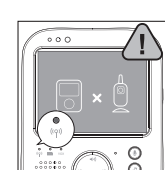
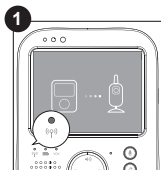

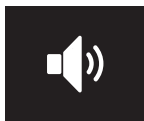

Volume

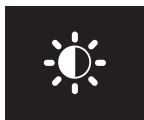
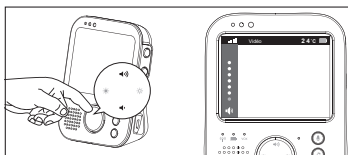

Luminosité

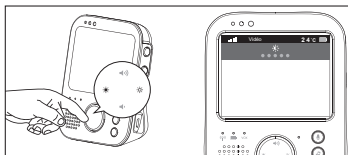

**Modes de
fonctionnement**

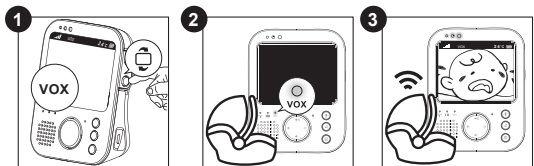
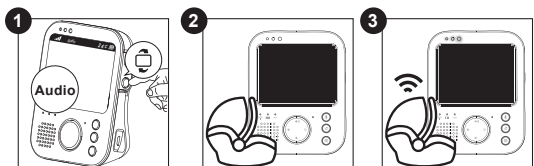
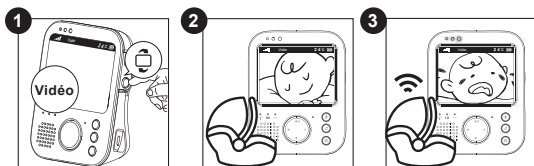

Veilleuse

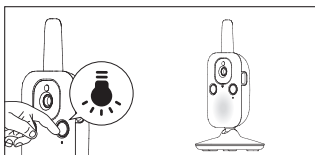



Berceuse apaisante

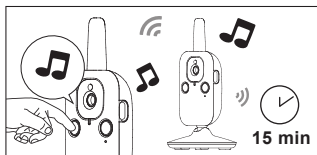
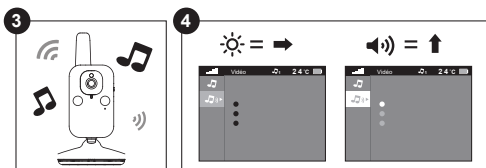
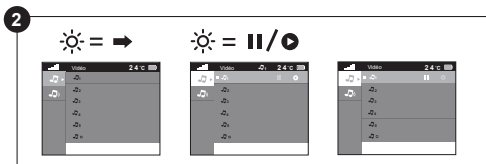
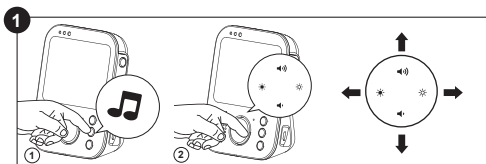

Conversation bidirectionnelle

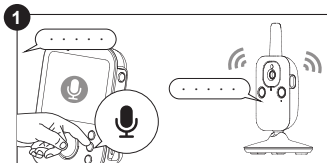

Menu

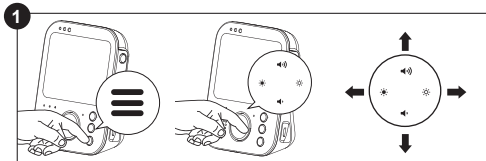



Zoom

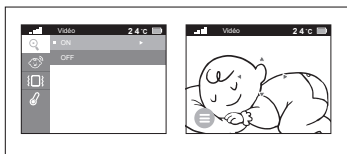

☉ Panoramique et inclinaison numériques



Activation vocale (VOX)

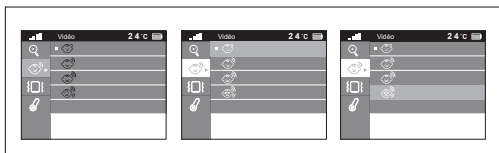

☉ Sensibilité faible/moyenne/élevée/très élevée (sourdine auto désactivée)



Vibration

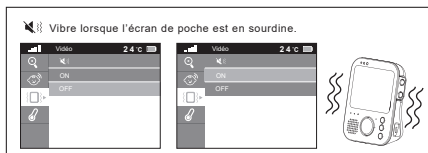

☉ Vibration ON : il vibre lorsqu'un son est détecté (déclenchement en fonction du niveau de sensibilité)



Réglage de la température

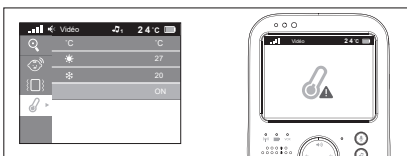
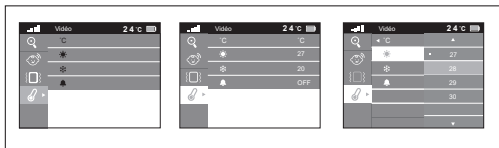



Warnung!

Strangulationsgefahr – Kinder können sich in Kabeln STRANGULIEREN. Halten Sie dieses Kabel von Kindern fern (mehr als 1 m entfernt). Entfernen Sie nicht das Etikett vom Kabel.

Lieferumfang

Babyeinheit *1

Elterneinheit *1

Netzteil *2

Wandmontageset *1

Kurzanleitung *1



Stromversorgung

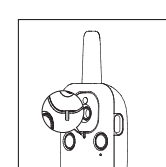
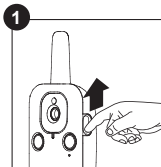
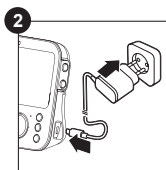
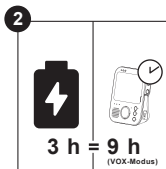
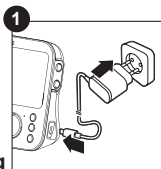

Verbindung

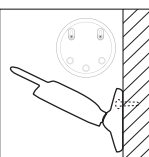
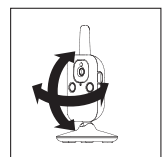
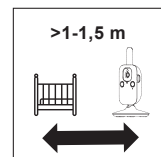
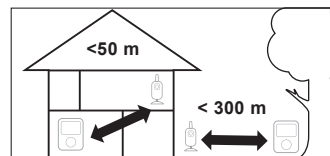
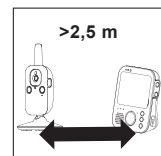
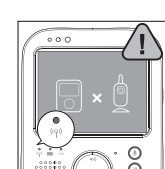
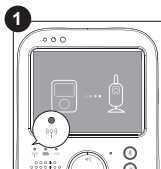

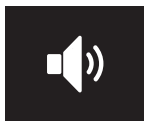

Lautstärke

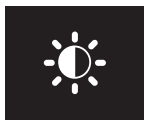
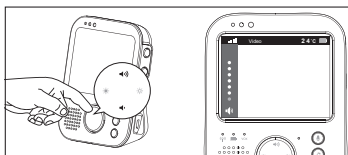

Helligkeit

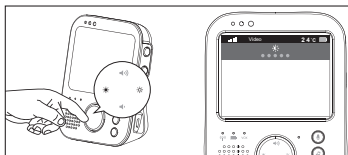

Betriebsmodus

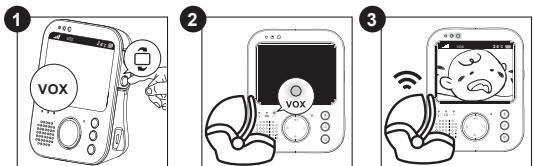
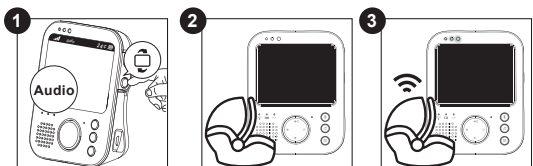
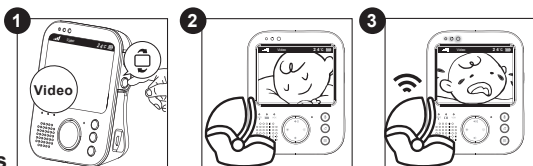

Nachtlicht

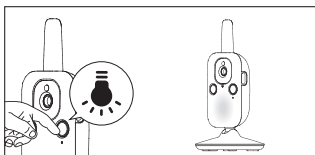



Beruhigendes Schlaflied

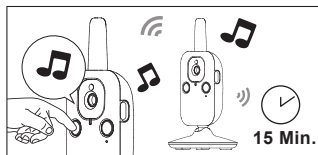
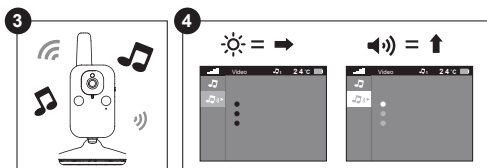
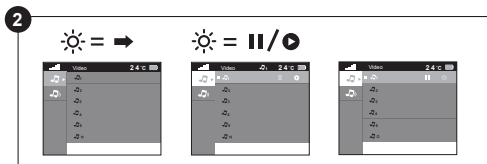
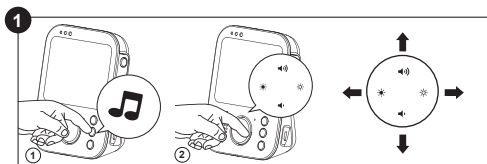

Gegensprech- funktion

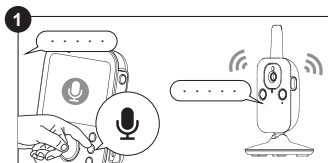

Menü

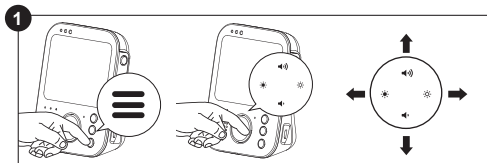



Zoom

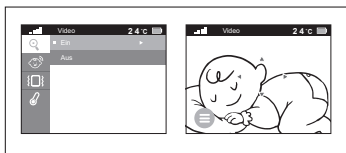

⊙ Digitales Schwenken und Neigen



Sprachaktivierung (VOX)

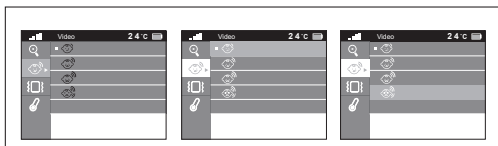

⊙ Empfindlichkeit gering/mittel/hoch/sehr hoch (automatische Stummschaltung deaktiviert)

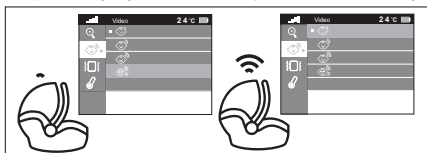

Vibration

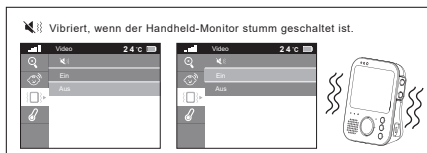

⊙ Vibration ein: Vibriert, wenn Geräusche erkannt werden (Auslösung entsprechend der Empfindlichkeitsstufe)



Temperatureinstellung

